

CERTIFICATE OF LOCATION OF GOVERNMENT CORNER

NORTHEAST Corner of Section 19, Township 105, Range 43, 5TH P.M.

STATE OF MINNESOTA, County of MURRAY

At the corner location shown on the sketch:

On 10-21-2008 found a 10" RED STONE
DATE

left monument as found, lowered monument, removed monument (explain)

On 10-21-2008 placed a 1" PIPE WITH SEAL #43844 OVER STONE.
DATE

SKETCH OF REFERENCE TIES

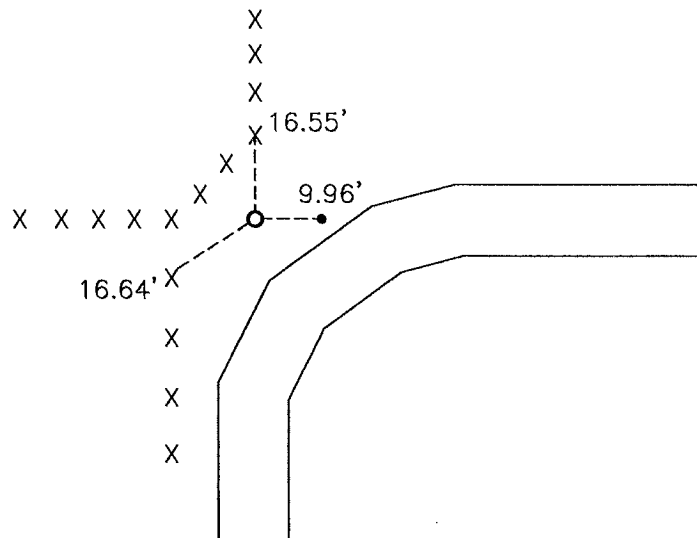

Minnesota State Plane Coordinate
System Murray County Datum
NAD83 (1996)

N: 116432.336
E: 426817.673

PK nail in wooden post North 16.55'
PK nail in wooden post SW 16.64'
Pipe with seal #42604 East 9.96'

Statement of evidence relative to this corner location is on back of page.

I hereby certify that this document and the data contained herein was prepared by me or under my direct supervision.

Samuel Butcher 3/5/09
SIGNATURE DATE

Registration No. 43844

Land Surveyor, Professional Engineer
 County Surveyor, County Engineer

OFFICE OF THE COUNTY RECORDER
County of

I hereby certify that this document was filed in the Co. Recorders office at _____ .M on the _____ day of _____ A.D. 20____

County Recorder *James V. Johnson*
By _____, Deputy

DOCUMENT NO. JUL 10 2009

Statement of Evidence

In 1866, J. W. Bishop did the original subdivision of the township.

On June 28, 1911, a stone in mound and 4 pits was set at the corner.

On August 10, 2006, a $\frac{1}{2}$ " pipe with seal #42604 was set 0.3' below surface.

On October 21, 2008, Bueltel-Moseng Land Surveying dug with a backhoe and found a 10" red stone with the remains of the old corner fence post $2'\pm$ below the surface. We also found a $\frac{1}{2}$ " pipe with seal #42604. We held to the stone and set a $\frac{3}{8}$ " iron with seal #43844 on the north side of the stone. We also set a 1" pipe with seal #43844 at the surface. It is at the intersection of the fence to the north and west.